

## K22 INDUSTRIAL COMPRESSOR RANGE

### FOR AIR AND NITROGEN



23 - 35 scfm

350 - 6000 psig



*K 22 compressor block*

**Companies that rely on absolute operating safety and investment security in their inspection or production processes have confidence in more than 50 years of BAUER-experience in High-Pressure Systems Technology.**

Whatever application you want to realize with medium or high pressure air or nitrogen, we support you in every respect.

Our service includes project planning, installation of complete turn-key systems, certifications of all kinds, and, of course, a reliable after sales service as well as a guaranteed spare parts supply for decades - worldwide.

## SCOPE OF SUPPLY

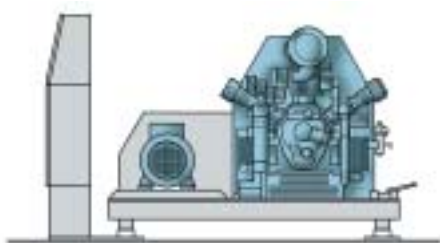

**OPEN:** length 2140 width 720 height 1250  
dimensions in mm:

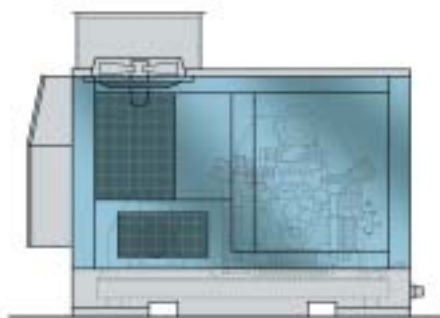

**SUPER SILENT:** length 2330 width 1190 height 1820  
dimensions in mm:

### Extensive standard scope of supply

**Air-cooled compressor block** with force-feed lubrication, interstage-and aftercoolers, interstage separators after each stage, final **oil- and water separator**.

**Final pressure safety valve**, pressure maintaining- and check valve.  
**Cycle counter** to register the load cycles in the oil- and water separator.  
**Automatic condensate drain device** with unloaded start and condensate collecting system 40 l.

**V-Belt driven 3phase motor** (400/690V, 50 Hz; special voltages upon request).  
**All components** mounted on a **common base frame** with **shock absorbers** for free-standing installation.

**Fully automatic** and programmable compressor control **B-CONTROL extended**.  
The **neat display** informs in **real time** about the **actual operating status** of the compressor, **maintenance work due** and compressor **configuration**.\*

**Gas intake line** is required if **nitrogen** is supposed to be compressed.\*\*

### Optional:

The **B-MESSENGER** transfers **information** from the B-CONTROL via **SMS** on the **mobile phone** or **fax**.

The **Super Silent Version** includes a **noise abating closed cabinet**.

\* monitored parameters:

interstage pressures, final pressure, oil pressure, temperature of all stages, cooling air temperature, motor overcurrent, maintenance intervals, control of condensate drain valves with cycle counter for final separator

\*\* consisting of:

particle filter, non-return-/solenoid valve, sensors for intake pressure monitoring min./max.

## TECHNICAL DATA

Model (air version)	Model (nitrogen version)	F.A.D. 1)	Speed	Drive	Net weight open version	Net weight Super Silent version
		scfm	rpm	kW	approx. kg	approx. kg
<b>3-stufig, 350 - 500 psig, 28 -35 scfm</b>						
A 22.5 - 11	AGI 22.5 - 11	28	1050	11	450	700
A 22.5 - 15	AGI 22.5 - 15	35	1310	15	460	710
<b>3-stufig, 400 - 900 psig, 24 -34 scfm</b>						
B 22.5 - 11	BGI 22.5 - 11	24	920	11	450	700
B 22.5 - 15	BGI 22.5 - 15	34	1310	15	460	710
<b>3-stufig, 900 - 1080 psig, 30 scfm</b>						
E 22.5 - 15	EGI 22.5 - 15	30	1150	15	460	710
<b>4-stufig, 1080 - 1300 psig, 23 - 34 scfm</b>						
E 22.0 - 11	EGI 22.0 - 11	23	900	11	480	730
E 22.0 - 15	EGI 22.0 - 15	28	1100	15	490	740
E 22.0 - 18,5	EGI 22.0 - 18,5	34	1300	18,5	510	760
<b>4-stufig, 1300 - 5000 psig, 23 - 33 scfm</b>						
I 22.0 - 15	GI 22.0 - 15	23	980	15	490	740
I 22.0 - 18,5	GI 22.0 - 18,5	28	1180	18,5	510	760
I 22.0 - 22	GI 22.0 - 22	33	1320	22	570	820
<b>4-stufig, 5000 - 6000 psig, 31 scfm</b>						
I 22.0 - 22-420	GI 22.0 - 420	31	1180	22	570	820

1) measured with flow meter at 0,8 factor of final pressure (±5%)



### BAUER KOMPRESSOREN GmbH

P.O.BOX 710260 · D-81452 MÜNCHEN  
 DRYGALSKI-ALLEE 37 · D-81477 MÜNCHEN  
 PHONE 0049 89 78049-0  
 FAX 0049 89 78049-167  
 Internet: [www.bauer-kompressoren.de](http://www.bauer-kompressoren.de)  
 e-mail: [info@bauer-kompressoren.de](mailto:info@bauer-kompressoren.de)